

- THE -
SHELL
GROTTO
MARGATE

Sensory Map
Entrance Level

 **Noisy space**

- Toilet (hand dryer)
- Entrance desk

 **Bright space**

- Large windows and skylights

 **Busy Space**

- Queue for toilet
- Entrance to Grotto

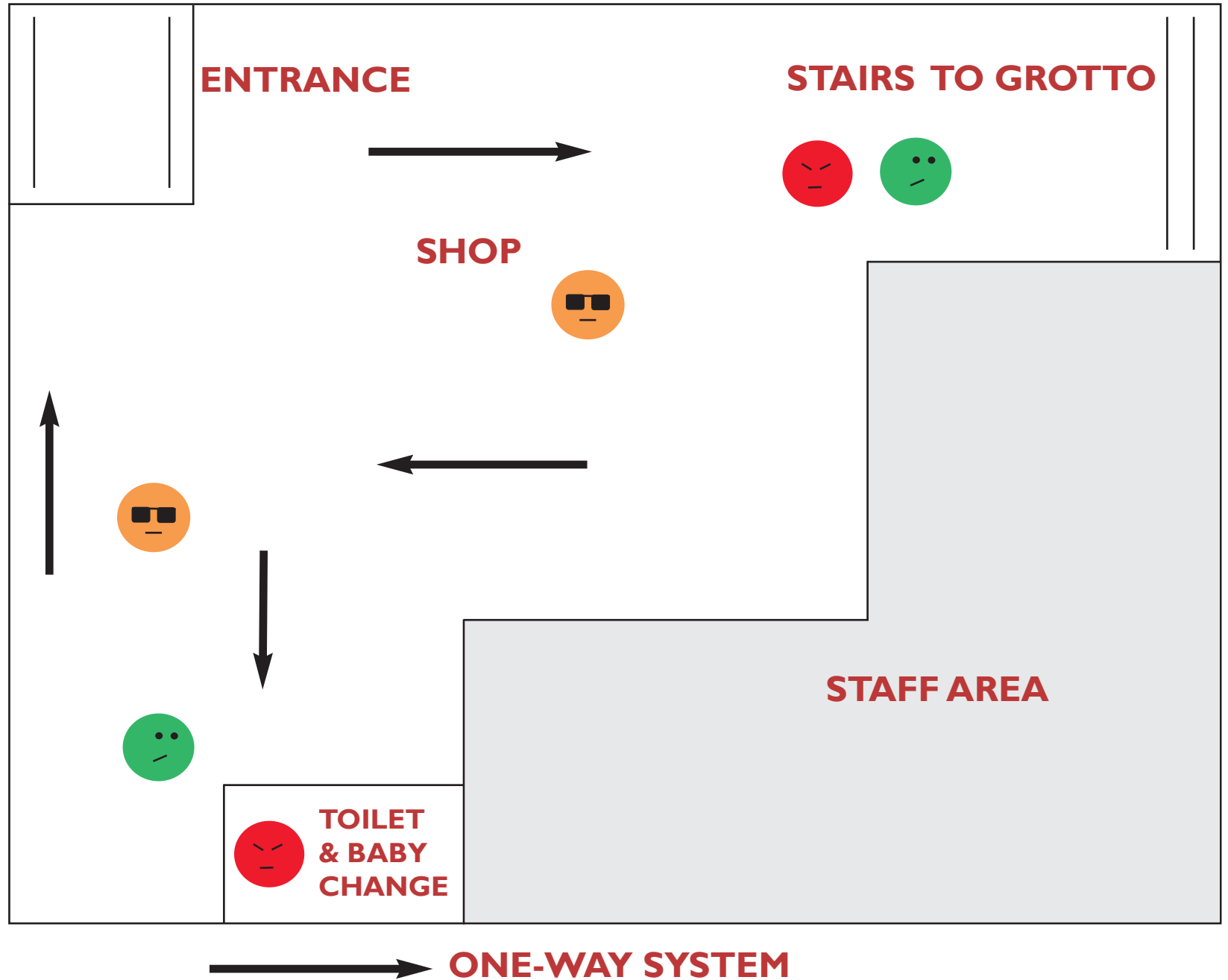

- THE -
**SHELL
GROTTO**
MARGATE

Sensory Map
Museum Room

 **Noisy space**
• Dehumidifier

 **Dark space**
• This room is dimly lit

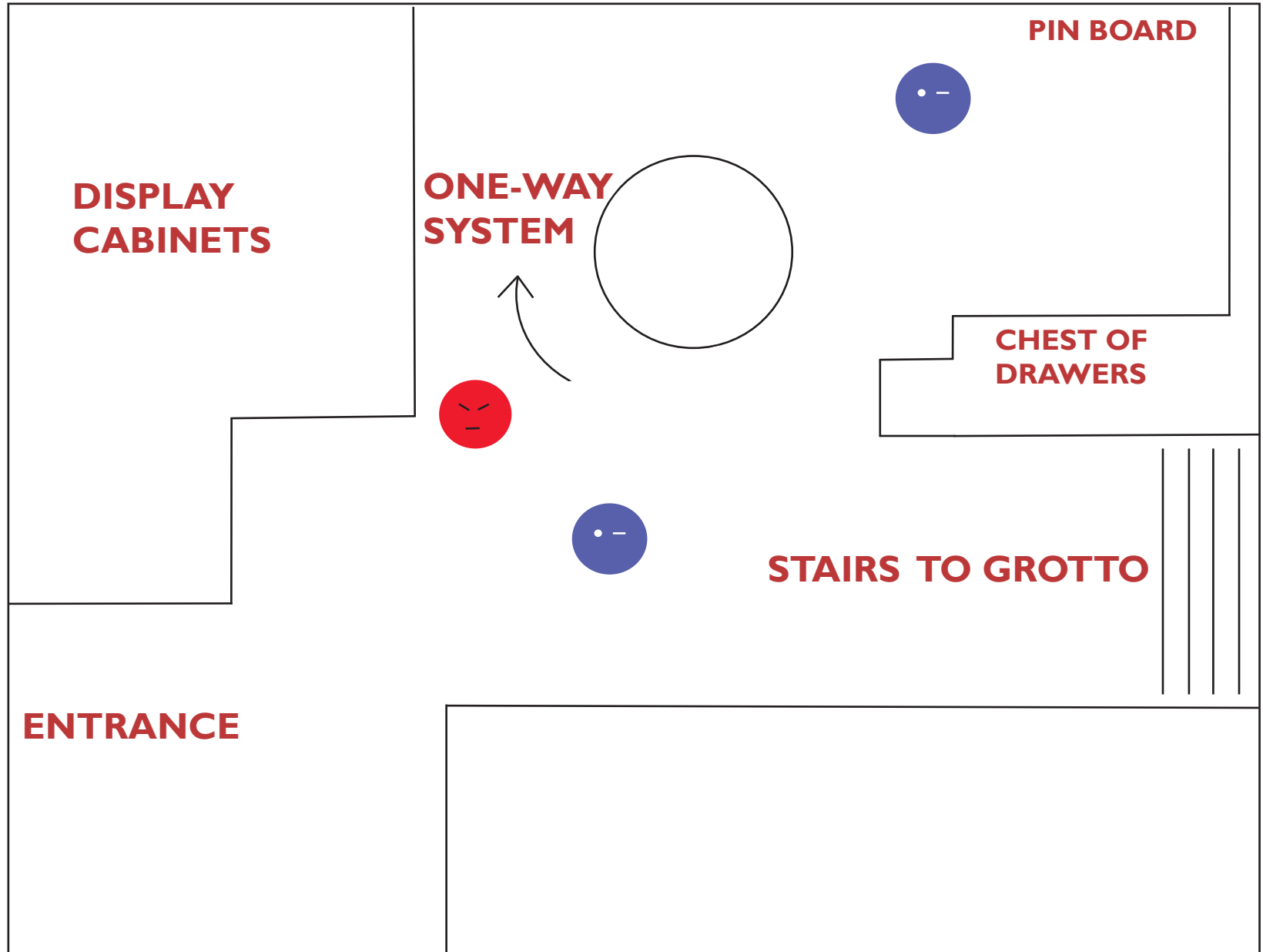

- THE -
**SHELL
GROTTO**
MARGATE

Sensory Map The Grotto

 Smelly space

- The Grotto can smell damp

 Dark space

- The Grotto is dimly lit

 Bright space

- Dome skylight

 Noisy space

- Extractor fan

**ENTRANCE
NORTH PASSAGE**

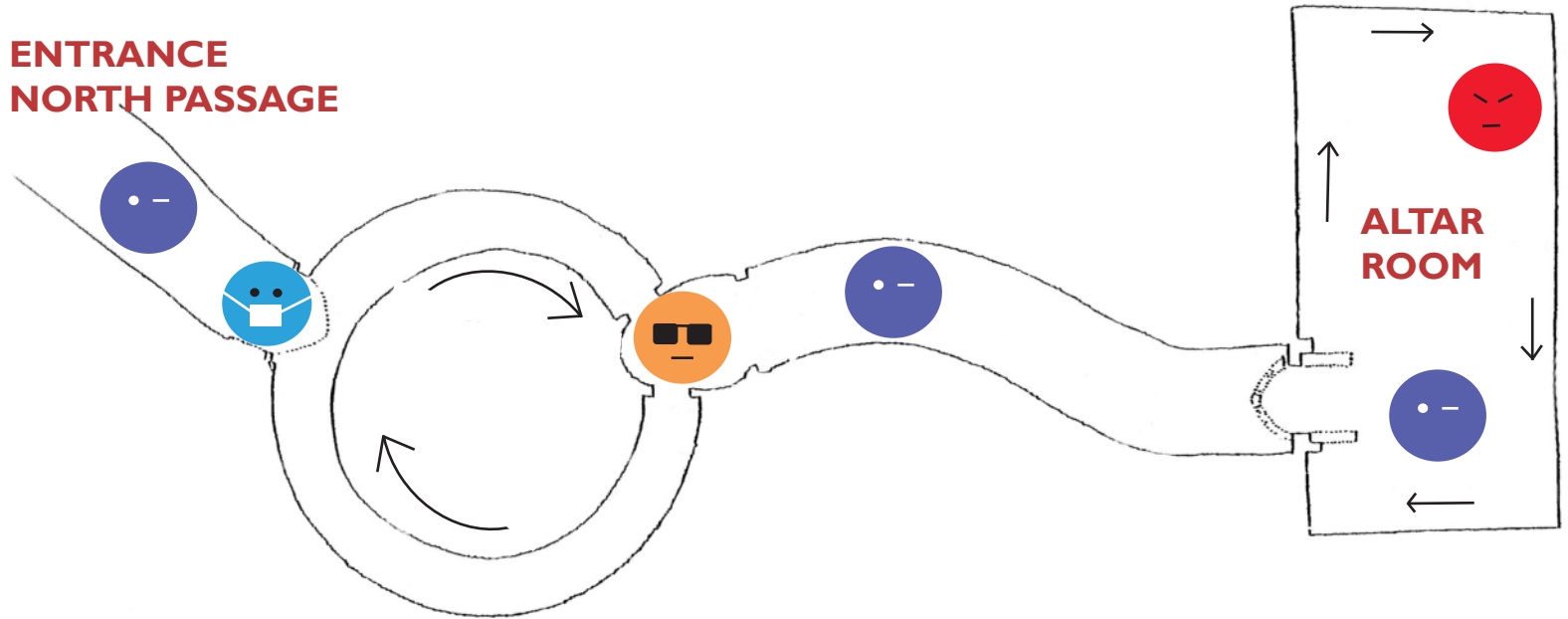

PLEASE

- Be considerate • Don't rush • Follow the one-way system
- Give way to people entering, who have right of way over those leaving, particularly at the North Passage and the Altar Room
- Keep children under close supervision • Pass with care
- Avoid touching the walls, as the shells are very delicate

THANK YOU